

FL60 COVER

SEAL

FL60 FRAME

Category: **ACCESS COVER & FRAME - SEALED**

Product Description: 600mm x 600mm flat sealed composite cover with an aluminium frame.

Page No: **1**

Product Code: **FL60**

Date: **May 2013**

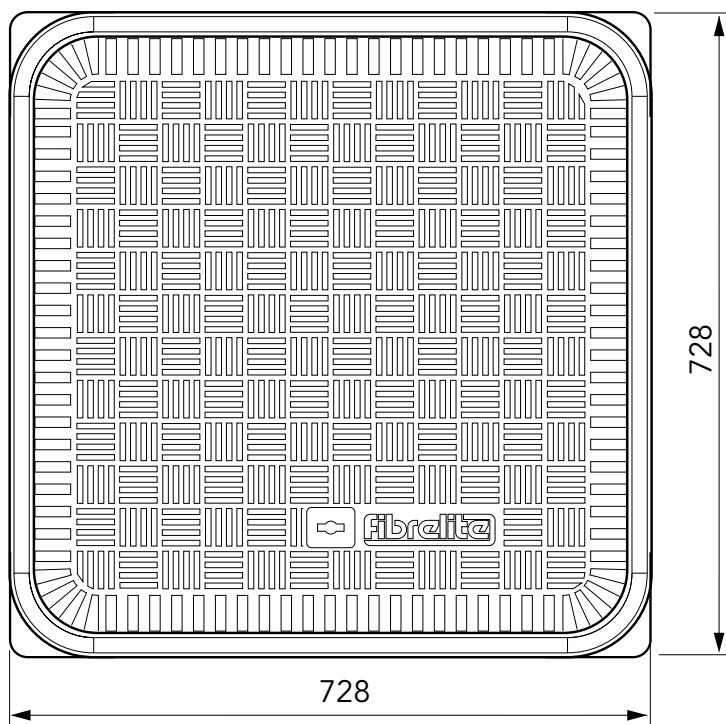
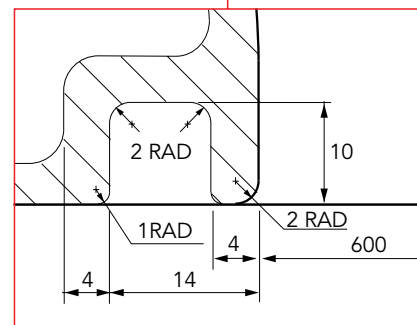
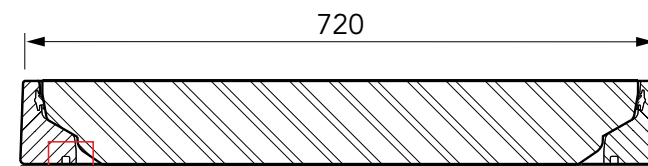
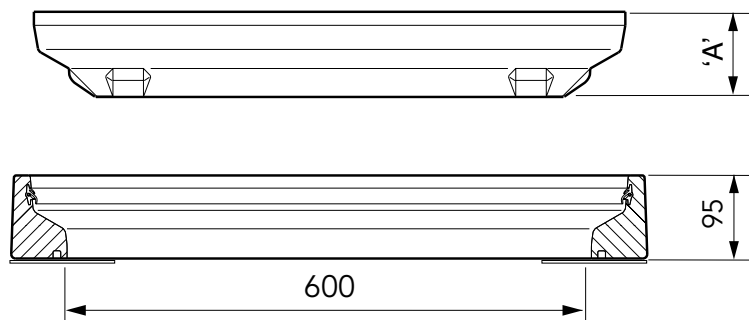

| Load Rating | Cover Weight (kg) | Frame Weight (kg) | Cover Height ('A') |
|-------------|-------------------|-------------------|--------------------|
| B125 | 12 | 11 | 63mm |
| C250 | 20 | 11 | 97.5mm |
| D400 | 24 | 11 | 97.5mm |
| F900 | 33 | 11 | 97.5mm |

Category: **ACCESS COVER & FRAME - SEALED**

Product Description: 600mm x 600mm flat sealed composite cover with an aluminium frame.

Page No: **2**

Product Code: **FL60**

Date: **May 2013**

CONCRETE

VERY IMPORTANT

OUTER EDGE "A" OF FRAME SET 5MM ABOVE GENERAL FORECOURT AREA WITH CONCRETE RAMPED AWAY OVER 300MM

VERY IMPORTANT

The underside of the frame must be adequately supported by concrete.

Expansion joint filled with petrol resistant mastics.

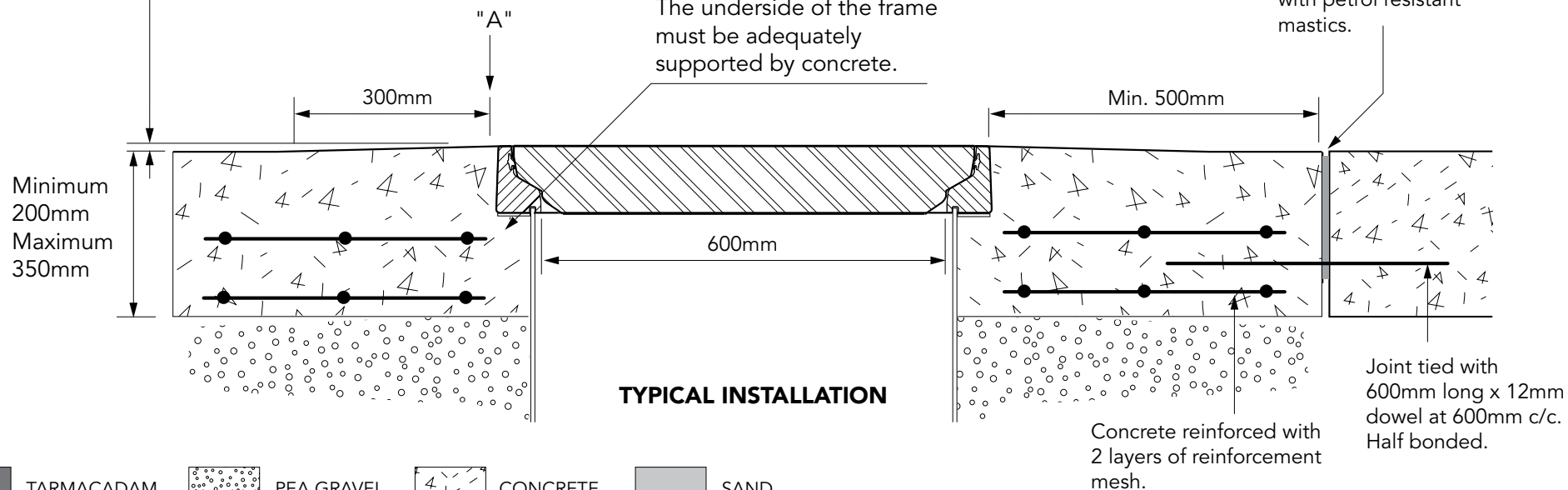

TARMACADAM

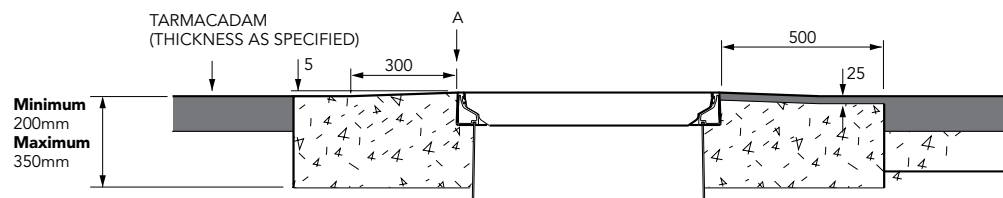

SETTS

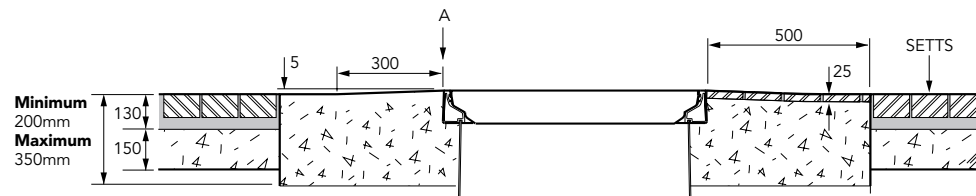

Category: **ACCESS COVER & FRAME - SEALED**

Product 600mm x 600mm flat sealed composite cover with an aluminium frame.
 Description:

Page No: **3**

Product Code: **FL60**

Date: **May 2013**

